

COLUMN BLOCK

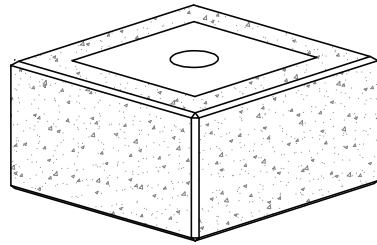

COLUMN BLOCK FOR
CONDUIT/REINFORCEMENT

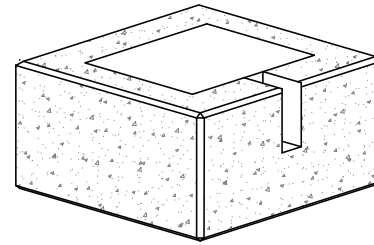

COLUMN BLOCK FOR
FENCE RAIL - END

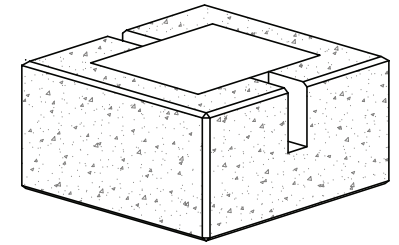

COLUMN BLOCK FOR
FENCE RAIL - RUNNER

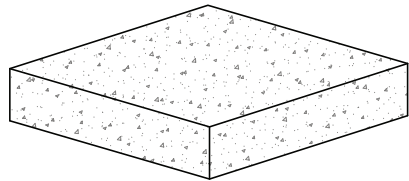

COLUMN CAP

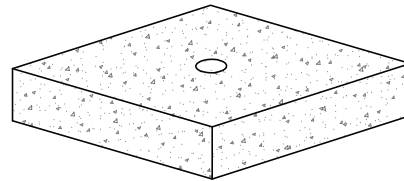

COLUMN CAP
FOR CONDUIT

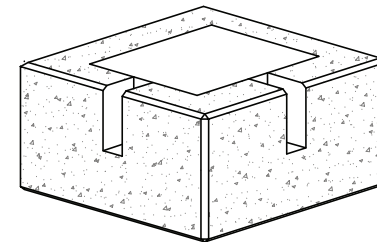

COLUMN BLOCK FOR
FENCE RAIL - CORNER

© Copyright 2016 ReCon Wall Systems, Inc. All Rights Reserved

Disclaimer: This drawing has been prepared by ReCon Wall Systems, Inc. and to the best of its knowledge, accurately represents the product use in the application that it is illustrated. This drawing is intended for conceptual purposes only. Anyone making use of this drawing does so at their own risk and assumes all liability for such use. Final design for construction purposes must be completed by a Registered Professional Engineer who is familiar with the product and who has taken into account specific site conditions.



DRAWING #901

COLUMN BLOCK TYPES

RECON WALL SYSTEMS, INC.
7600 W. 27th STREET, #229
ST. LOUIS PARK, MN 55426
952-922-0027
www.reconwalls.com

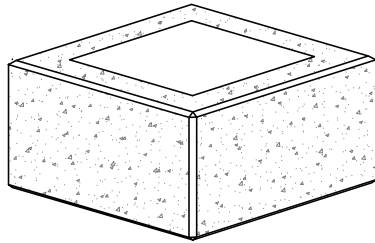

COLUMN BLOCK

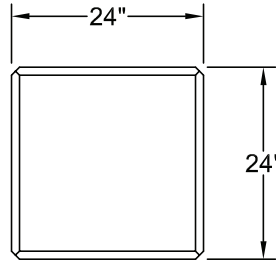

TOP VIEW

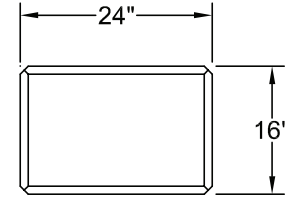

SIDE VIEW

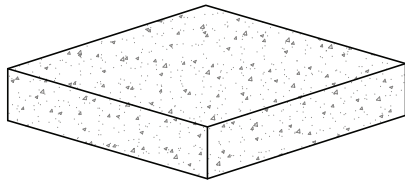

COLUMN CAP

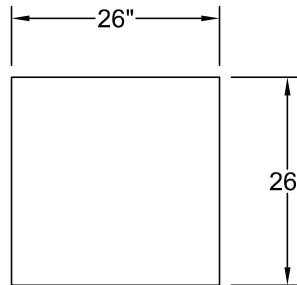

TOP VIEW

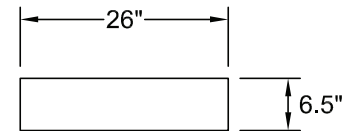

SIDE VIEW

© Copyright 2016 ReCon Wall Systems, Inc. All Rights Reserved

Disclaimer: This drawing has been prepared by ReCon Wall Systems, Inc. and to the best of its knowledge, accurately represents the product use in the application that it is illustrated. This drawing is intended for conceptual purposes only. Anyone making use of this drawing does so at their own risk and assumes all liability for such use. Final design for construction purposes must be completed by a Registered Professional Engineer who is familiar with the product and who has taken into account specific site conditions.



DRAWING #902

COLUMN BLOCK DIMENSIONS

RECON WALL SYSTEMS, INC.
7600 W. 27th STREET, #229
ST. LOUIS PARK, MN 55426
952-922-0027
www.reconwalls.com

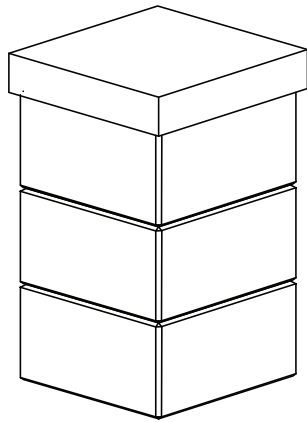

ISOMETRIC VIEW
FREE STANDING COLUMN

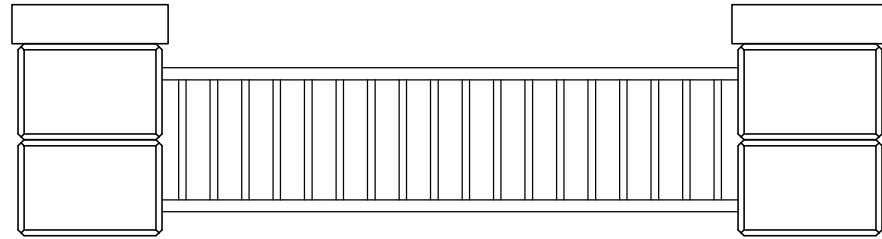

PROFILE VIEW
FREE STANDING COLUMNS
WITH 24" RAILING

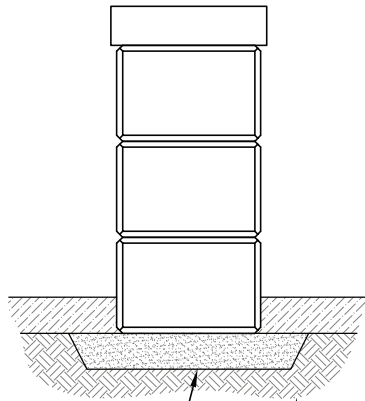

MIN. 6" GRANULAR MATERIAL
COMPACTED TO MIN. 95%
STANDARD PROCTOR OR
UNREINFORCED CONCRETE

FOUNDATION SOIL:
SUB-CUT AS REQ'D AND REPLACE w/
COMPACTED STRUCTURAL FILL TO
ACHIEVE ADEQUATE BEARING CAPACITY

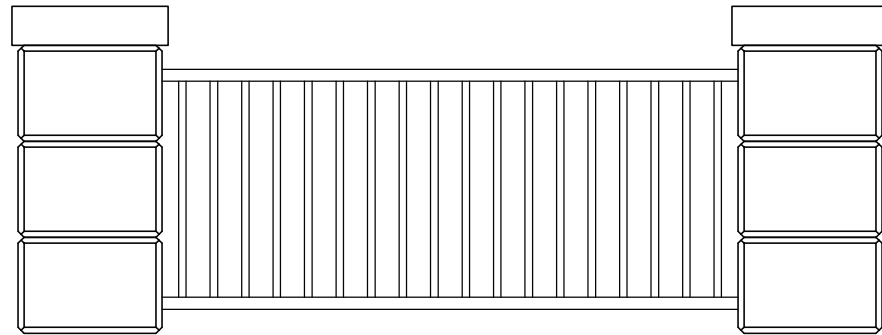

PROFILE VIEW
FREE STANDING COLUMNS
WITH 40" RAILING

© Copyright 2016 ReCon Wall Systems, Inc. All Rights Reserved

Disclaimer: This drawing has been prepared by ReCon Wall Systems, Inc. and to the best of its knowledge, accurately represents the product use in the application that it is illustrated. This drawing is intended for conceptual purposes only. Anyone making use of this drawing does so at their own risk and assumes all liability for such use. Final design for construction purposes must be completed by a Registered Professional Engineer who is familiar with the product and who has taken into account specific site conditions.



DRAWING #903

COLUMN BLOCK APPLICATIONS

RECON WALL SYSTEMS, INC.
7600 W. 27th STREET, #229
ST. LOUIS PARK, MN 55426
952-922-0027
www.reconwalls.com

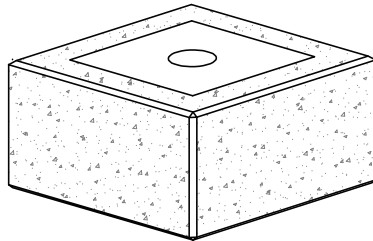

COLUMN BLOCK
FOR CONDUIT/REINFORCEMENT

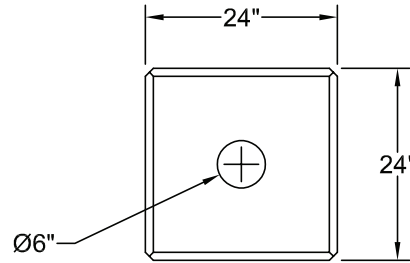

TOP VIEW

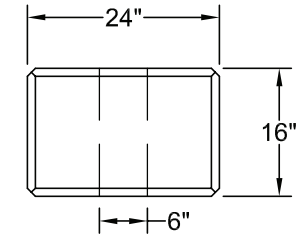

SIDE VIEW

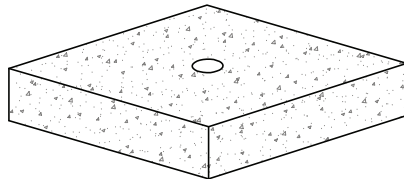

COLUMN CAP
FOR CONDUIT

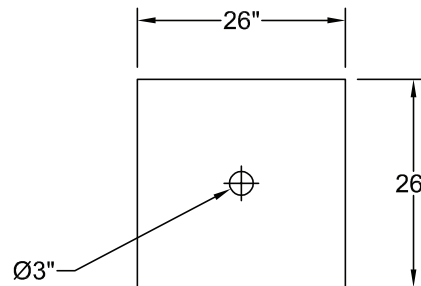

TOP VIEW

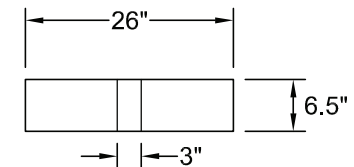

SIDE VIEW

© Copyright 2016 ReCon Wall Systems, Inc. All Rights Reserved

Disclaimer: This drawing has been prepared by ReCon Wall Systems, Inc. and to the best of its knowledge, accurately represents the product use in the application that it is illustrated. This drawing is intended for conceptual purposes only. Anyone making use of this drawing does so at their own risk and assumes all liability for such use. Final design for construction purposes must be completed by a Registered Professional Engineer who is familiar with the product and who has taken into account specific site conditions.



DRAWING #904

COLUMN BLOCK CONDUIT DIMENSIONS

RECON WALL SYSTEMS, INC.
7600 W. 27th STREET, #229
ST. LOUIS PARK, MN 55426
952-922-0027
www.reconwalls.com

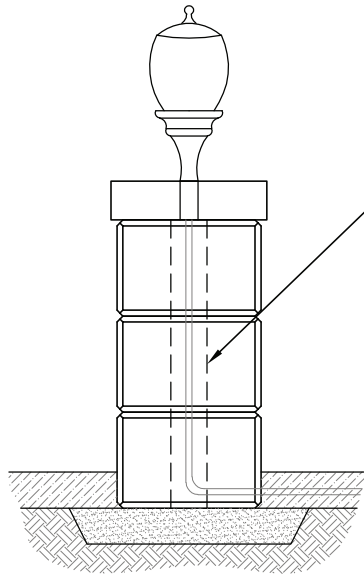

SECTION VIEW
COLUMN WITH LIGHTING

CONDUIT MAY BE PLACED WITHIN
THE OPEN CORE TO PROVIDE
ELECTRICAL ACCESS FOR LIGHTING

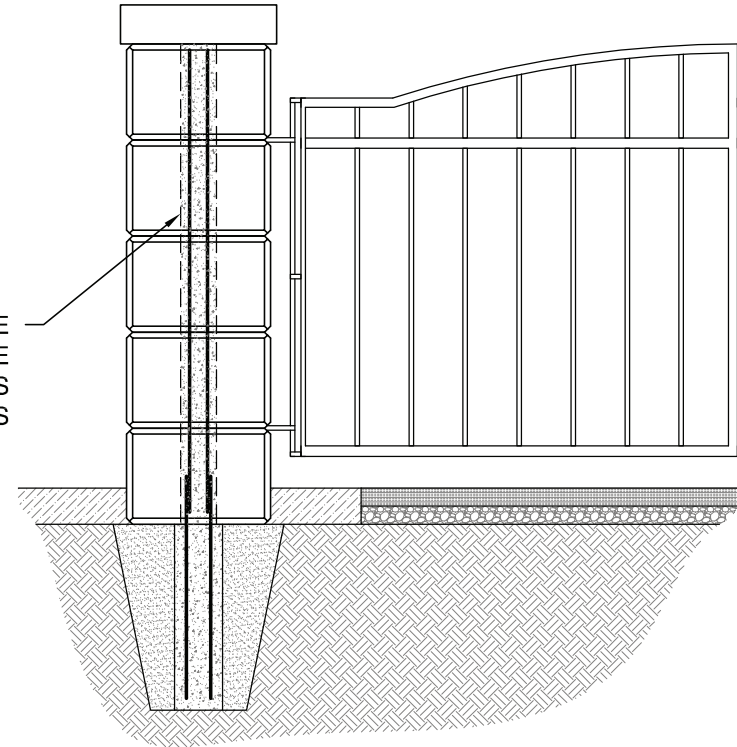

SECTION VIEW
COLUMN WITH FENCE/GATE

GROUT AND REBAR MAY BE
PLACED WITHIN THE OPEN CORE
TO CREATE TALLER COLUMNS
FOR FENCES AND GATES

© Copyright 2016 ReCon Wall Systems, Inc. All Rights Reserved

Disclaimer: This drawing has been prepared by ReCon Wall Systems, Inc. and to the best of its knowledge, accurately represents the product use in the application that it is illustrated. This drawing is intended for conceptual purposes only. Anyone making use of this drawing does so at their own risk and assumes all liability for such use. Final design for construction purposes must be completed by a Registered Professional Engineer who is familiar with the product and who has taken into account specific site conditions.

ReConTM
Retaining Walls

DRAWING #905

**COLUMN BLOCK CONDUIT
APPLICATIONS**

RECON WALL SYSTEMS, INC.
7600 W. 27th STREET, #229
ST. LOUIS PARK, MN 55426
952-922-0027
www.reconwalls.com

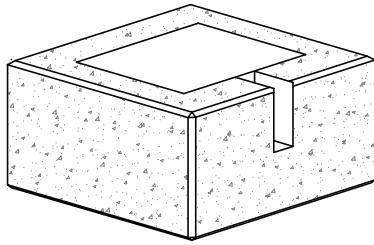

COLUMN BLOCK
FOR FENCE RAIL - END

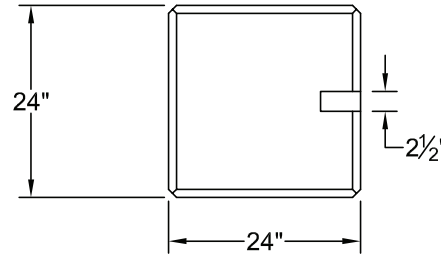

TOP VIEW

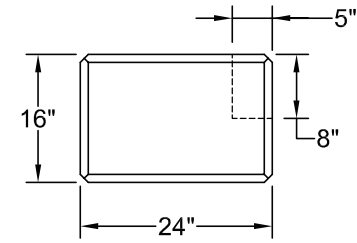

SIDE VIEW

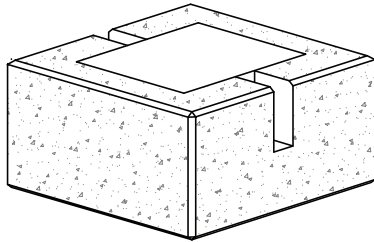

COLUMN BLOCK
FOR FENCE RAIL - RUNNER

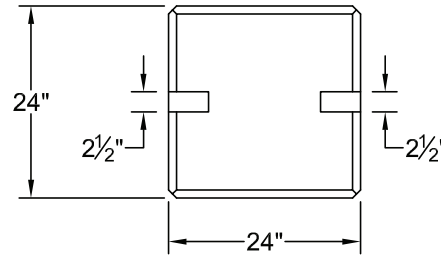

TOP VIEW

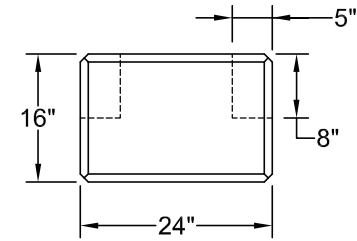

SIDE VIEW

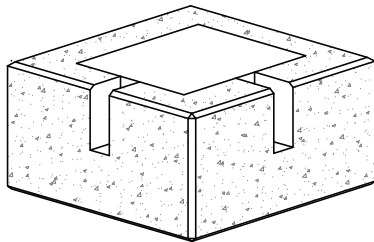

COLUMN BLOCK
FOR FENCE RAIL - CORNER

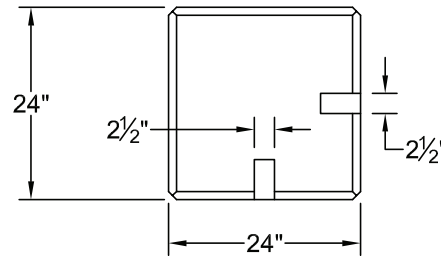

TOP VIEW

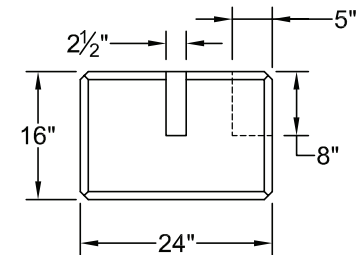

SIDE VIEW

© Copyright 2016 ReCon Wall Systems, Inc. All Rights Reserved

Disclaimer: This drawing has been prepared by ReCon Wall Systems, Inc. and to the best of its knowledge, accurately represents the product use in the application that it is illustrated. This drawing is intended for conceptual purposes only. Anyone making use of this drawing does so at their own risk and assumes all liability for such use. Final design for construction purposes must be completed by a Registered Professional Engineer who is familiar with the product and who has taken into account specific site conditions.



DRAWING #906

COLUMN BLOCK FENCE DIMENSIONS

RECON WALL SYSTEMS, INC.
7600 W. 27th STREET, #229
ST. LOUIS PARK, MN 55426
952-922-0027
www.reconwalls.com

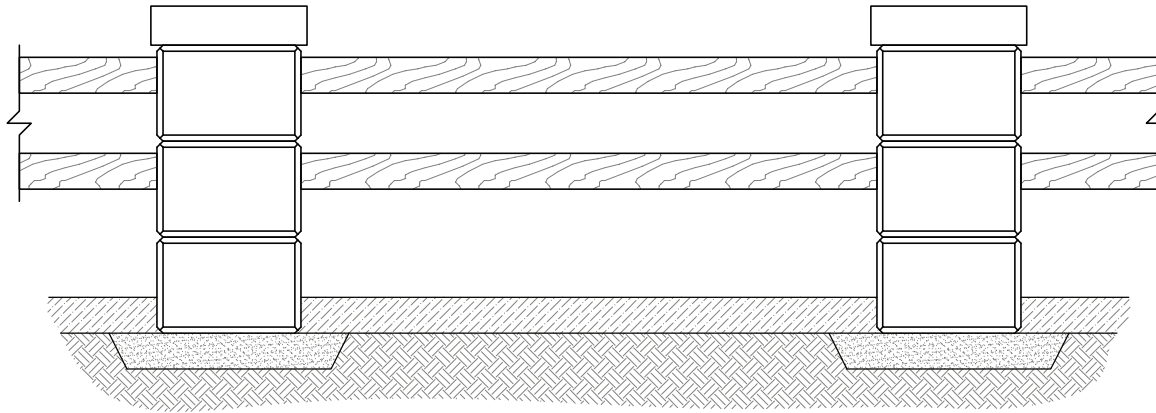

PROFILE VIEW
COLUMN BLOCKS WITH FENCE

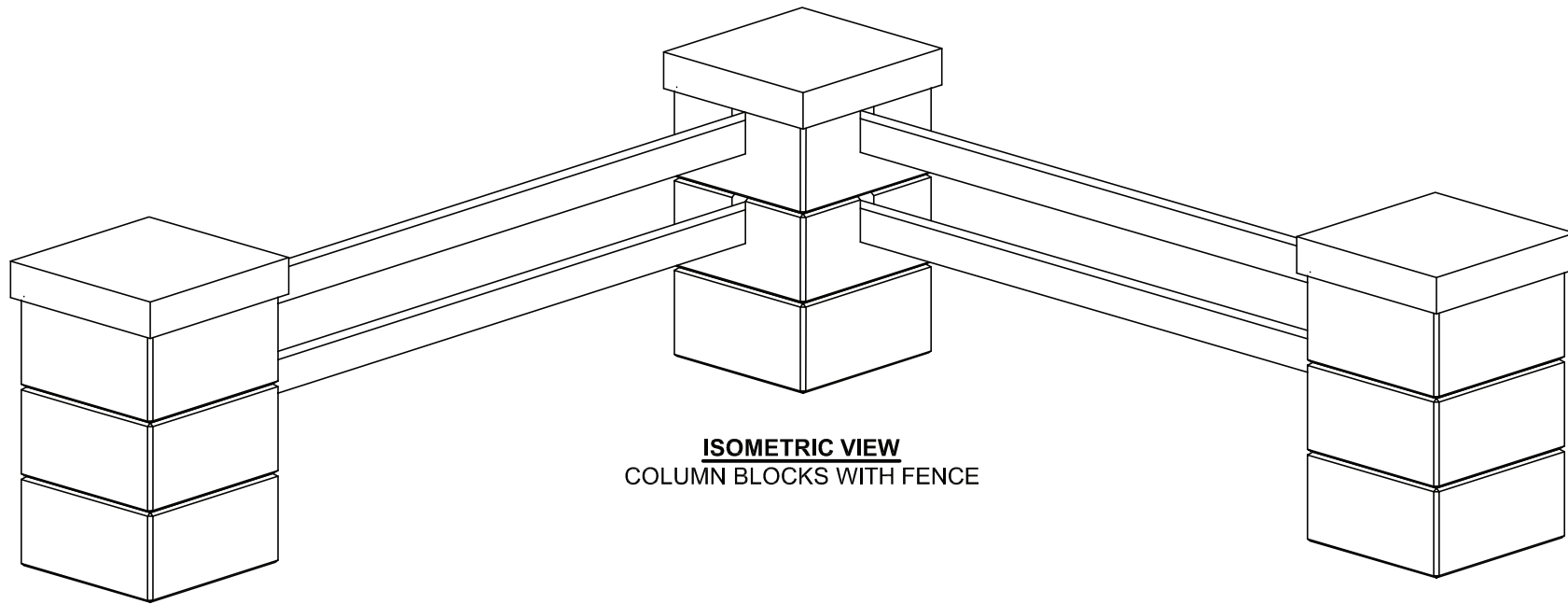

ISOMETRIC VIEW
COLUMN BLOCKS WITH FENCE

© Copyright 2016 ReCon Wall Systems, Inc. All Rights Reserved

Disclaimer: This drawing has been prepared by ReCon Wall Systems, Inc. and to the best of its knowledge, accurately represents the product use in the application that it is illustrated. This drawing is intended for conceptual purposes only. Anyone making use of this drawing does so at their own risk and assumes all liability for such use. Final design for construction purposes must be completed by a Registered Professional Engineer who is familiar with the product and who has taken into account specific site conditions.

ReConTM
Retaining Walls

DRAWING #907

**COLUMN BLOCK FENCE
APPLICATIONS**

RECON WALL SYSTEMS, INC.
7600 W. 27th STREET, #229
ST. LOUIS PARK, MN 55426
952-922-0027
www.reconwalls.com

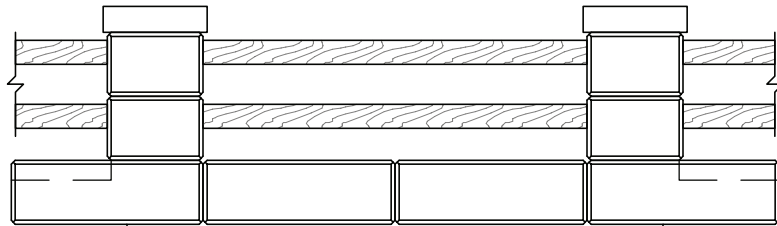

PROFILE VIEW
RECON WALL w/ COLUMN
BLOCK AND FENCE

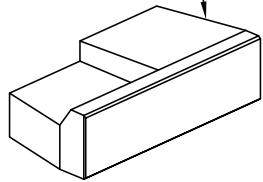

RECON HALF TOP
BLOCK (LEFT)

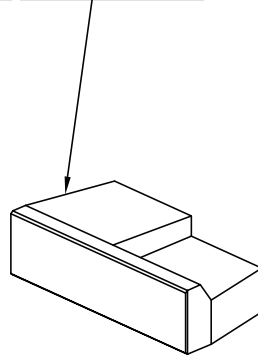

RECON HALF TOP
BLOCK (RIGHT)

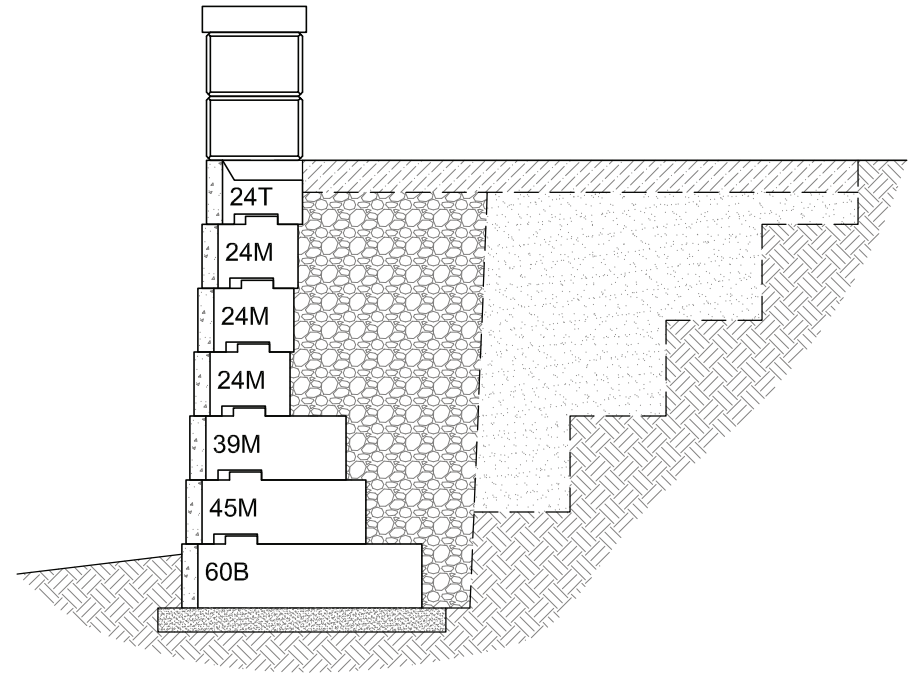

SECTION VIEW
RECON WALL w/ COLUMN
BLOCK AND FENCE

© Copyright 2016 ReCon Wall Systems, Inc. All Rights Reserved

Disclaimer: This drawing has been prepared by ReCon Wall Systems, Inc. and to the best of its knowledge, accurately represents the product use in the application that it is illustrated. This drawing is intended for conceptual purposes only. Anyone making use of this drawing does so at their own risk and assumes all liability for such use. Final design for construction purposes must be completed by a Registered Professional Engineer who is familiar with the product and who has taken into account specific site conditions.



DRAWING #908

COLUMN BLOCK TOP OF WALL APPLICATIONS

RECON WALL SYSTEMS, INC.
7600 W. 27th STREET, #229
ST. LOUIS PARK, MN 55426
952-922-0027
www.reconwalls.com